

## INSTRUCTIONS FOR MODELS

# S-2520

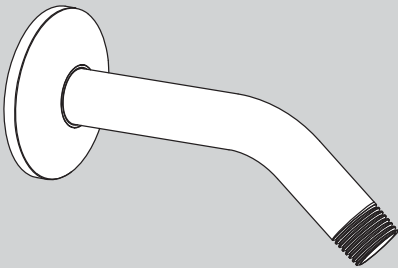

### NEED HELP?

For additional assistance or service please contact:

**SPEAKMAN**® Company  
400 Anchor Mill Road  
New Castle, DE 19720

 800-537-2107

 customerservice@speakman.com

 www.speakman.com

92-S-2520-R3

## TOOLS AND SUPPLIES

Thread Seal  
Tape



### IMPORTANT



Be sure to read instructions thoroughly before beginning installation. Do not overtighten any connections or damage may occur.

### SAFETY TIPS



Cover your drain to prevent loss of parts.

### MAINTENANCE



Your new Shower Arm is designed for years of trouble-free performance. Keep it looking new by cleaning it periodically with a soft cloth. Avoid abrasive cleaners, steel wool and harsh chemicals as these will dull the finish and void your warranty.

### WARRANTY



Additional warranty information can be found at:  
[www.speakman.com](http://www.speakman.com)

- 1** Slide Escutcheon Plate (2) over the long end of the Shower Arm (1).

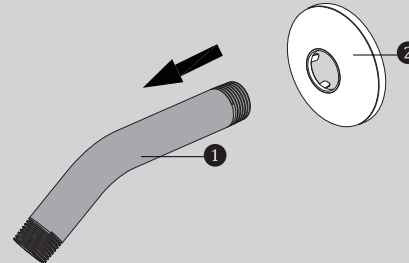

- 2** Apply Teflon Tape to inlet side of Shower Arm (1). Thread Shower Arm (1) into Female Pipe Fitting within the wall. Firmly tighten, and make sure Shower Arm (1) Outlet is pointing in a downward position.

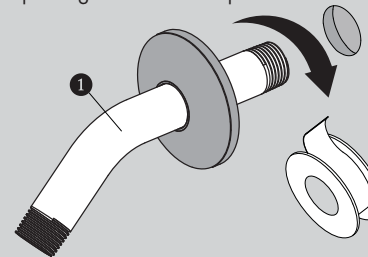

- 3** Position Escutcheon Plate (2) flat against wall.

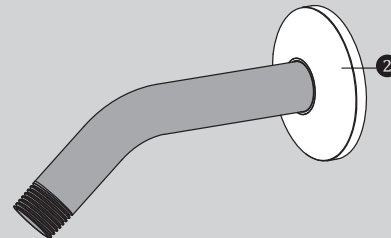

## ROUGH IN DIMENSIONS

$\varnothing 2\frac{1}{2}''$   
[63mm]

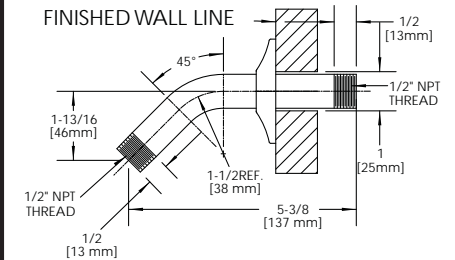
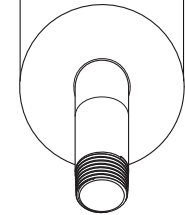

### Specifications:

Supply Inlet: 1/2" NPT MALE

Outlet: 1/2" NPT MALE