

## INSTALLATION INSTRUCTIONS

### SB-4601 Single Lever Faucet

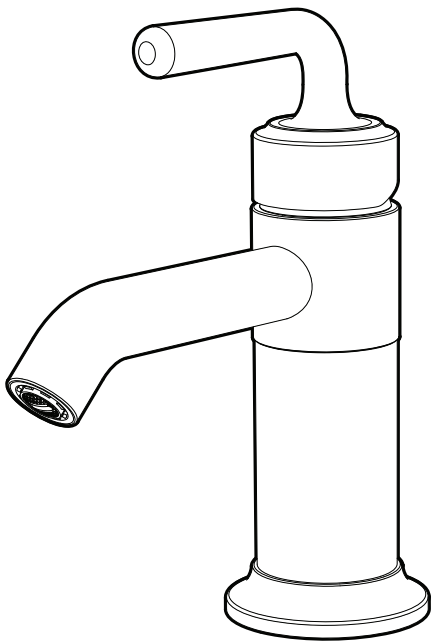

92-SB-4601-02

## TOOLS & SUPPLIES NEEDED

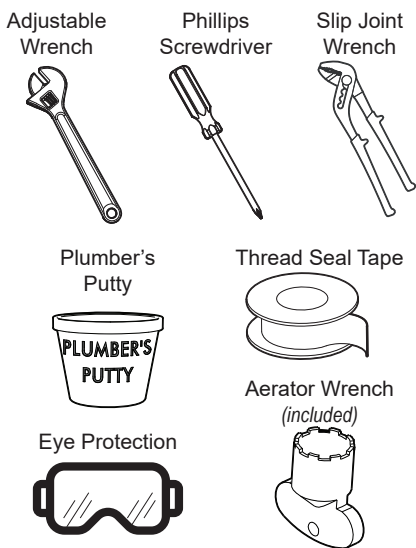

## IMPORTANT

### SAFETY TIPS:

Be sure to read and understand all instructions before beginning installation.  
Inspect all connections after installation.  
Cover the drain to avoid loss of parts.  
Be sure to wear proper eye protection.  
Do NOT over tighten any connections or damage may occur.  
This faucet has an operating range of 20-80psi

### FINISH MAINTENANCE:

Your new product is designed for years of trouble-free performance. Keep it looking new by cleaning it periodically with a soft cloth. Avoid abrasive cleaners, steel wool, and harsh chemicals as these will dull the finish and void your warranty.

## OPTIONAL SLEEVE INSTALL

This Faucet has the capability of becoming a two-tone product. To change out the Sleeve, unthread the Base Flange and Mounting Hardware from the Faucet (A). Unthread and replace the Sleeve with the optional Sleeve of a different finish (B). Reinstall removed components.

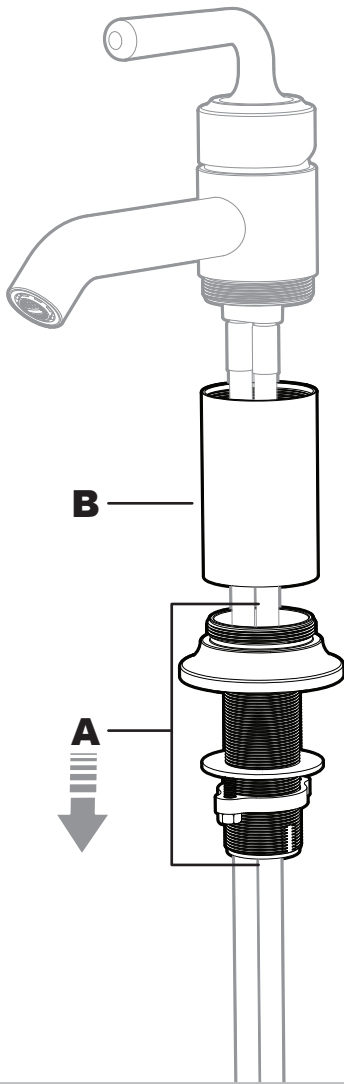

## PREPARE FOR MOUNTING

- 1 If Mounting Hardware is pre-installed, remove Mounting Nut and Washer.

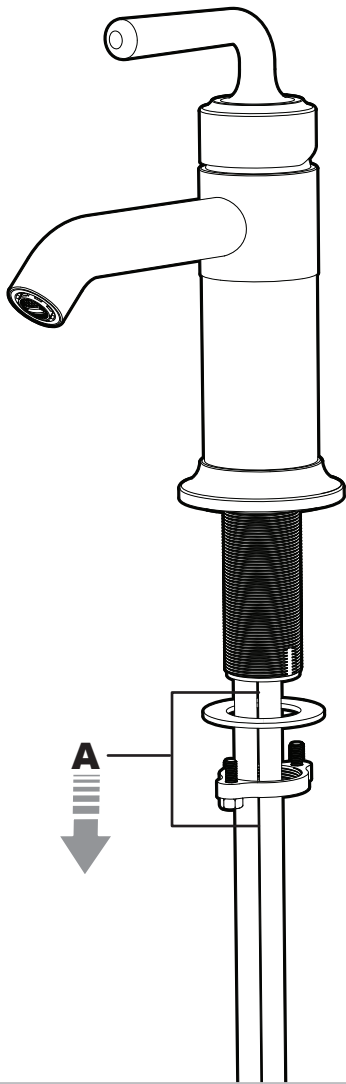

**NEED HELP?**  
For additional assistance or service please contact:



800-537-2107



www.speakman.com

## POSITION FAUCET

- 2 Place Hoses, one at a time, through hole in mounting surface. Lower Faucet into position.

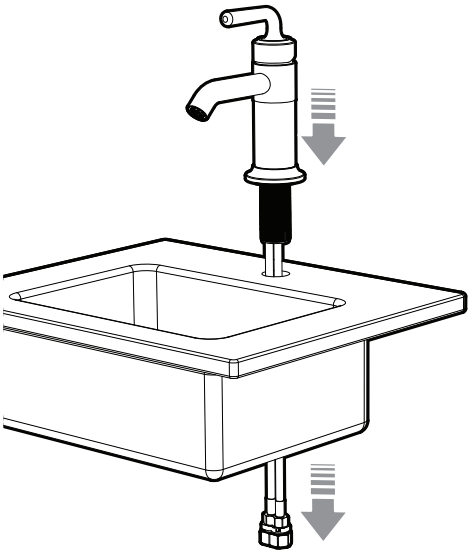

## SECURE INTO POSITION

- 3 From below, install Washer (A), and Mounting Nut (B). Align Faucet to desired position and tighten Screws within Mounting Nut (C).

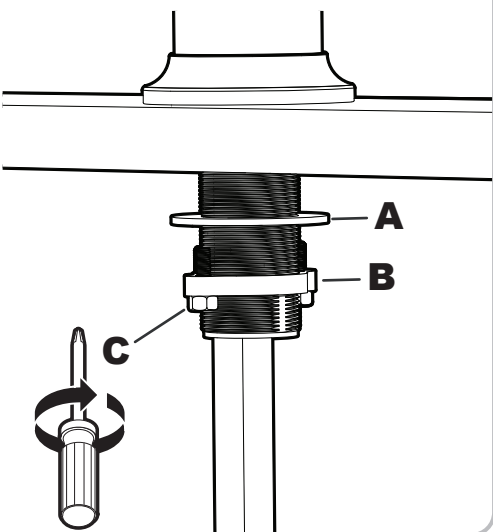

## MAKE WATER CONNECTIONS

- 4 Make connections to water supplies. The inlet threads of the faucet are 9/16"-24 UNEF and will accept a 3/8" Compression Fitting. HOT and COLD hoses are clearly marked. Wrench Tighten.

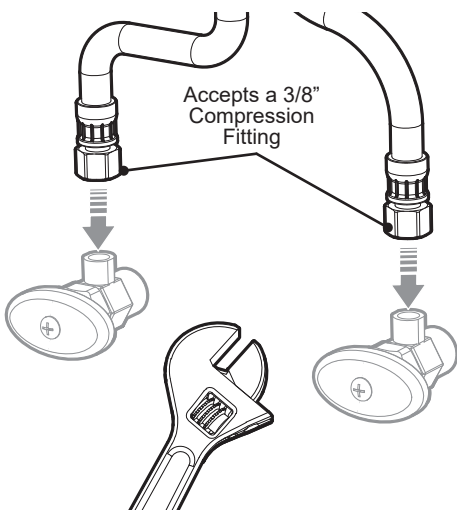

## REMOVE AERATOR

- 5 Remove Aerator with included Aerator Wrench.

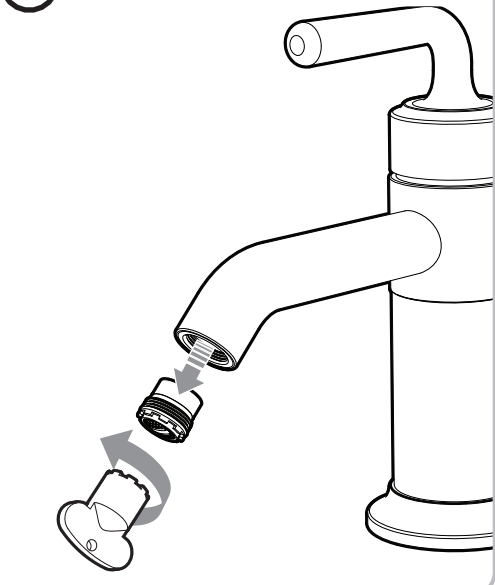

## PREPARE DRAIN

- 6 Remove Mounting Nut (A), Metal Washer (B), and Sealing Washer (C) from Drain Assembly.

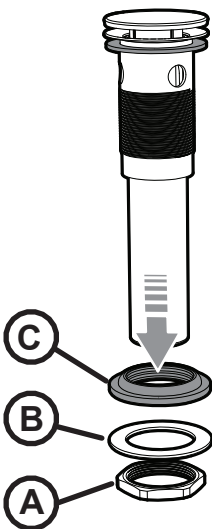

## POSITION DRAIN

- 7 Apply included Upper Drain Seal (A) or Plumber's Putty to the underside of the Upper Flange. Insert Drain Assembly into drain hole of sink from above.

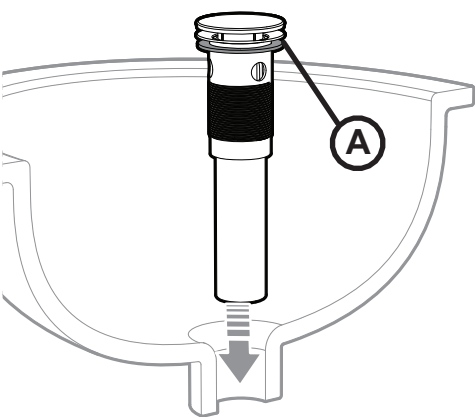

## SECURE DRAIN

- 8 From below, reinstall Sealing Washer (C), Metal Washer (B), and secure with Mounting Nut (A). Tighten with Slip Joint Pliers. Take care to not over-tighten connection.

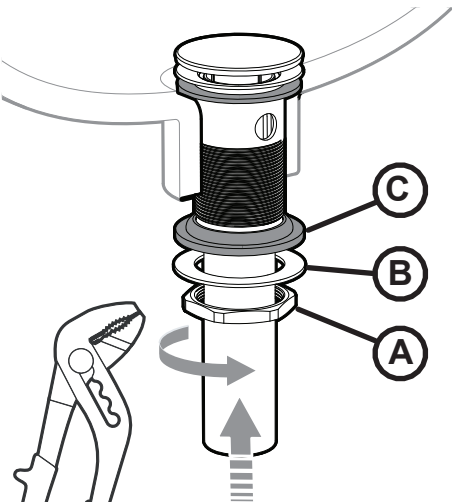

## TEST DRAIN

- 9 Test Drain operation by pressing down on Stopper to open/close Drain.

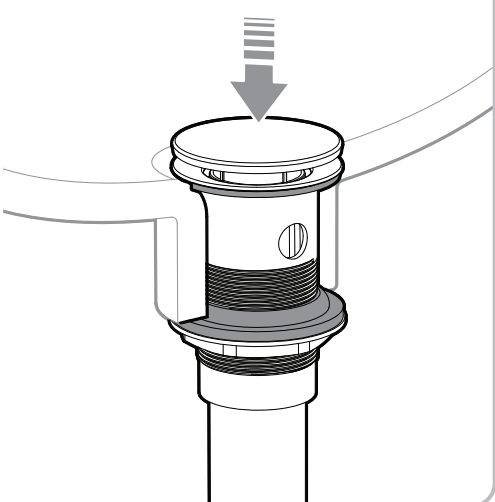

## FLUSH SYSTEM

- 10** Turn ON Water Supplies and check for leaks. Activate faucet and flush both HOT and COLD water for 1 minute.

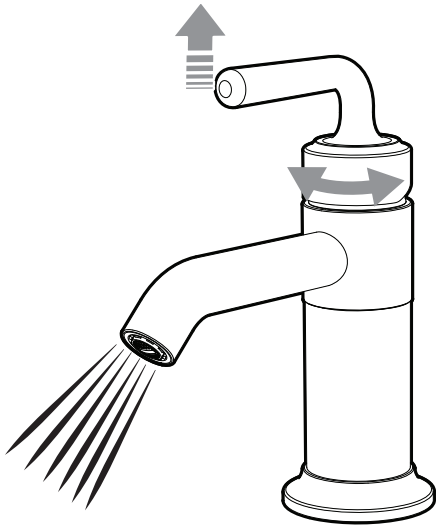

## INSTALL AERATOR

- 11** Install Aerator with included Aerator Wrench.

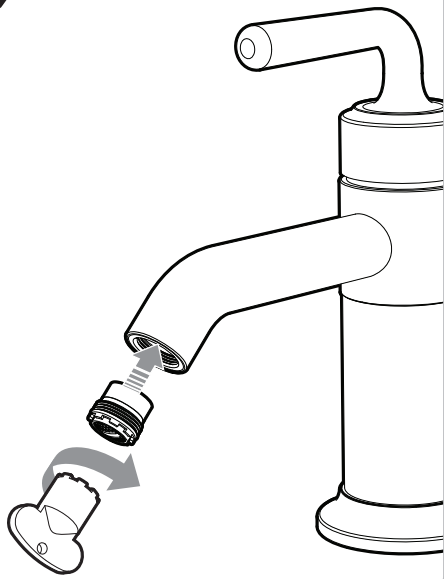

## REPAIR PARTS

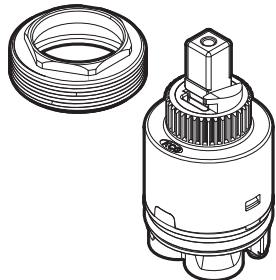

**RPG05-1112**  
CARTRIDGE AND  
RETAINING NUT

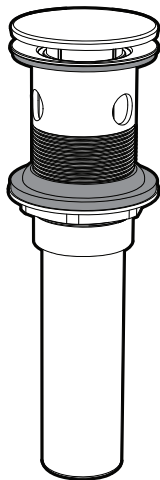

**S-3480-XX**  
DRAIN ASSEMBLY  
(XX = FINISH)

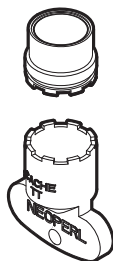

**RPG05-122255**  
AERATOR AND WRENCH

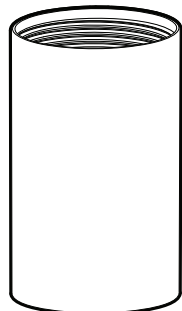

**A-SLF-XX**  
FINISH SLEEVE  
(XX = FINISH)

## PRODUCT WARRANTY

For additional information please go to [www.speakman.com](http://www.speakman.com).

## CALIFORNIA PROPOSITION 65



**CALIFORNIA PROPOSITION 65:**  
**WARNING:** This product can expose you to chemicals including lead, which is known to the State of California to cause cancer and birth defects or other reproductive harm. For more information go to [www.P65Warnings.ca.gov](http://www.P65Warnings.ca.gov). Wash hands after installation, repair, or removal of this product.

## ROUGH IN DIAGRAM

### CONNECTIONS:

Hot Supply- 9/16"-24 (3/8 compression)  
Cold Supply- 9/16"-24 (3/8 compression)

Contractor to supply necessary connections  
not included with product.

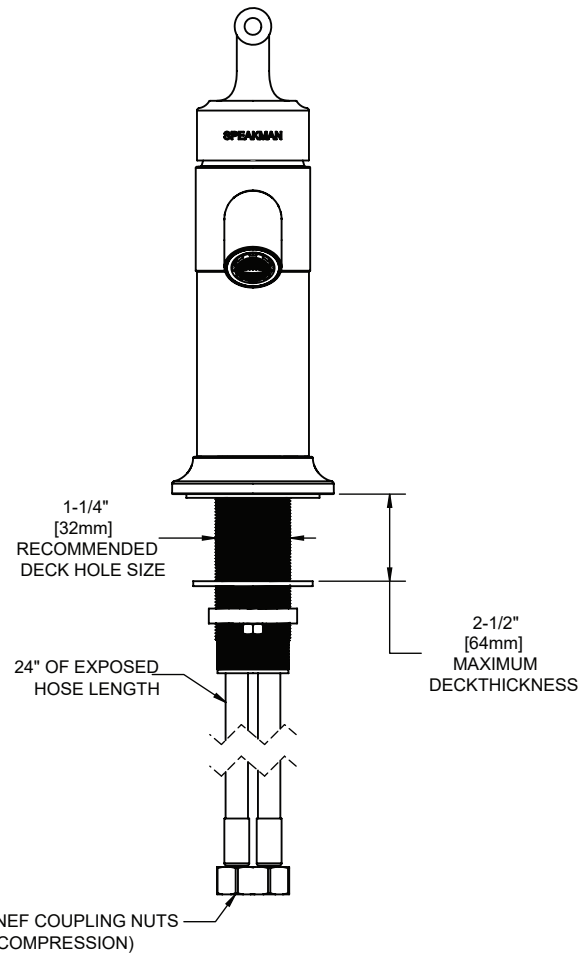
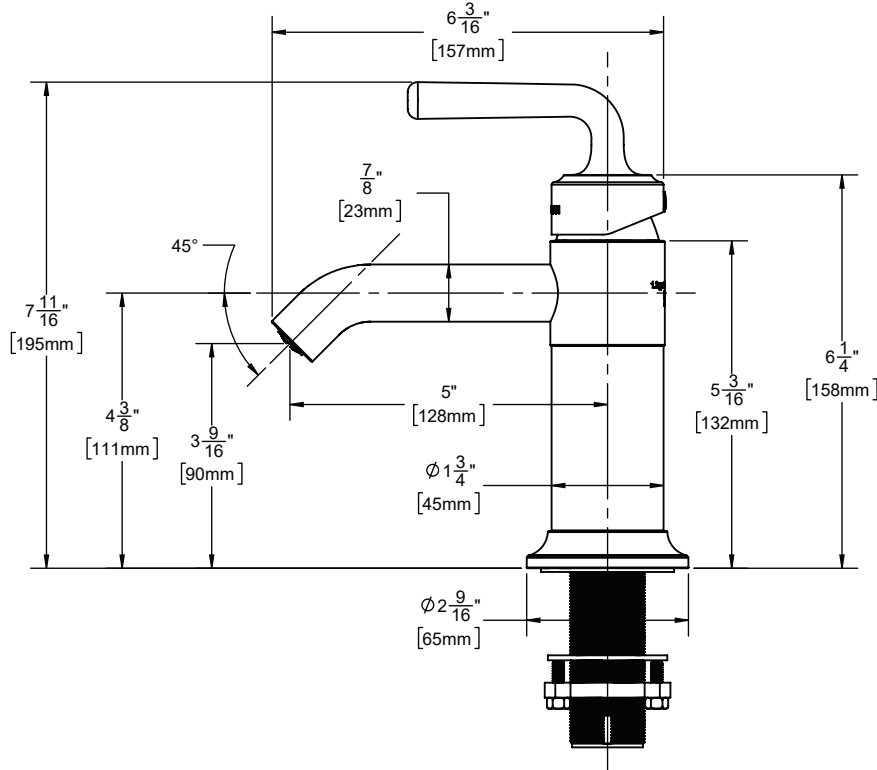

## LAVATORY ROUGH-IN

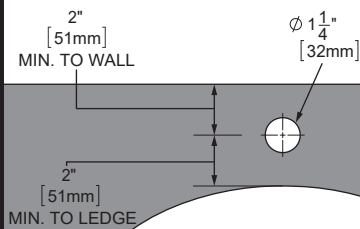

DIMENSIONS SUBJECT TO CHANGE WITHOUT NOTICE. FOR ADA MOUNTING LOCATIONS, CONSULT ADAAG, ANSI A117.1, AND LOCAL/STATE REGULATIONS.