

## Eyesaver® Faucet with Eyewash/Drench Hose and TMV

### EYEWASH FEATURES:

- Eyewash is connected to Speakman SC-5811-RCP service sink faucet's cold water integral stop port supply
- Activated by squeeze valve with automatic stay open device
- (2) yellow plastic spray heads with flip top dust caps
- 3.06 gpm @ 30 psi performance (eyewash only)
- 2.66 gpm @ 30 psi (with sink on)
- Integral vacuum breaker and check valve
- STW-370 thermostatic mixing valve

### FAUCET FEATURES:

- ½ in. NPT female inlets supply
- Vandal resistant four-arm handles with color coded indexes
- Perfect® valves with ¼ turn ceramic cartridges
- 4 gpm (min) @ 20 psi
- Cast brass nozzle with ¾ in. hose thread, pail hook and top brace outlet
- Integral vacuum breaker

### STANDARDS:

- 4WH: 4 in. wrist blade handles for service sink
- 5H: 5 ft. hose with hook
- CK: Check valves in swivel assembly

### STANDARDS:

- ASME A112.18.1/CSA B125 compliant
- ANSI/ISEA Z358.1 certified
- ASSE -1001 (service sink)

### WARRANTY:

Visit [www.speakman.com](http://www.speakman.com) for full product warranty information

- 3 Year Limited Warranty (commercial)

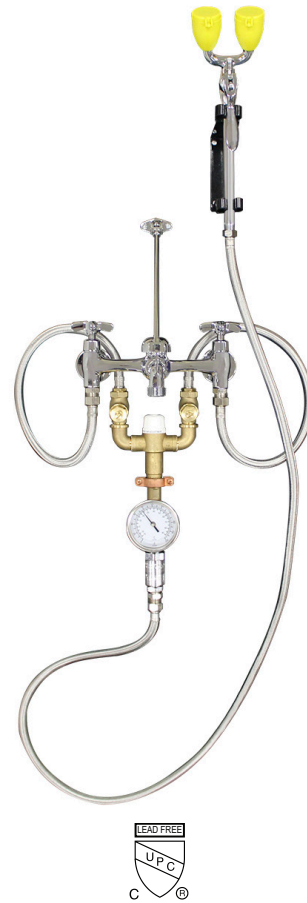

1. All dimensions are in inches (millimeters) unless otherwise specified and are subject to change without notice. 2. Mixing valve can be hard piped with unions.

Architect/Engineer Approval Space:

P: 800-537-2107  
F: 800-977-2747  
W: WWW.SPEAKMAN.COM  
R: 02-APRIL 2023

## Eyesaver® Faucet with Eyewash/Drench Hose and TMV

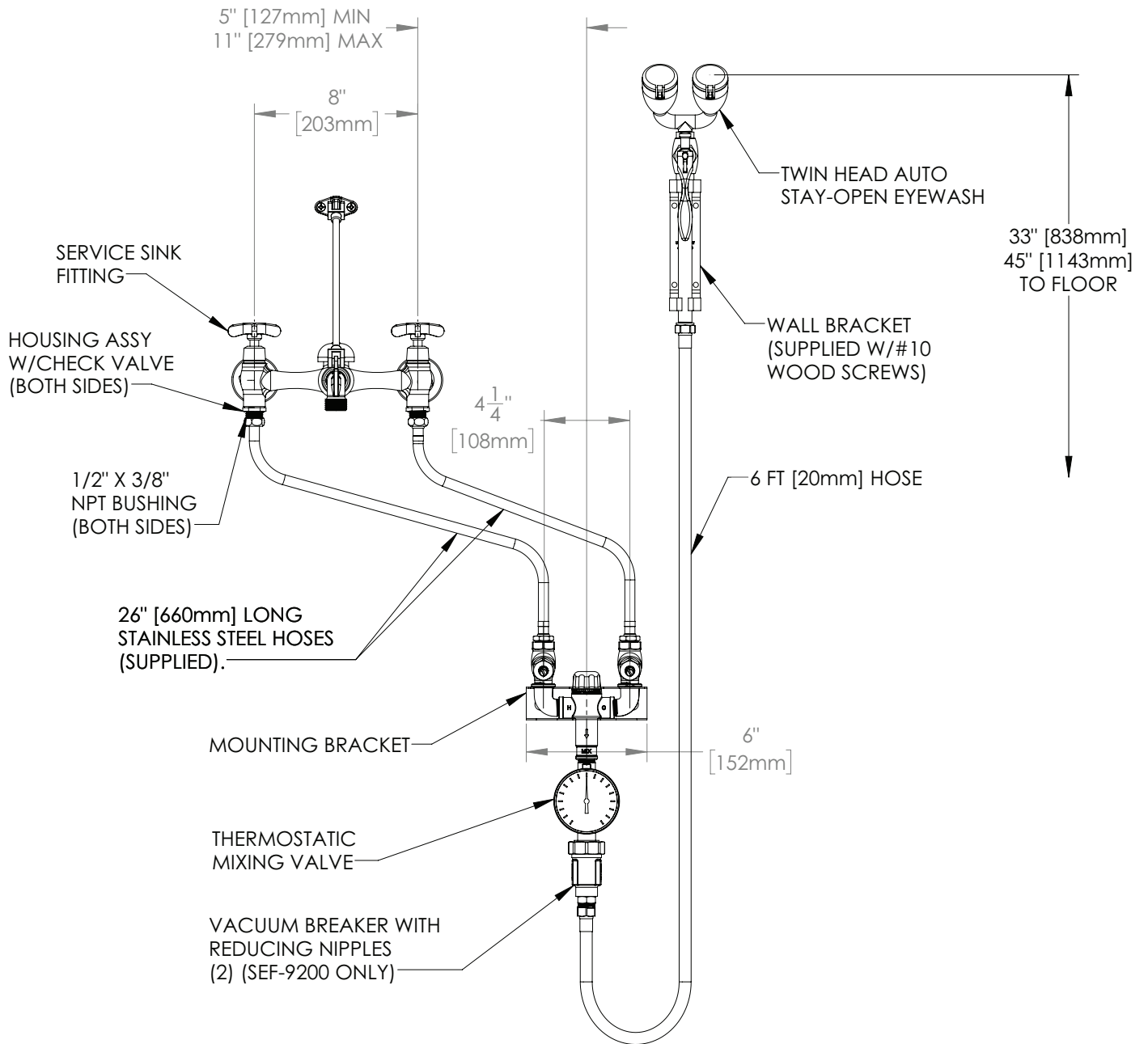

1. All dimensions are in inches (millimeters) unless otherwise specified and are subject to change without notice. 2. Mixing valve can be hard piped with unions.

Architect/Engineer Approval Space:

P: 800-537-2107

F: 800-977-2747

W: WWW.SPEAKMAN.COM

R: 02-APRIL 2023