

Anti-Ligature Trim and and Shower Combination (Valve not included)

MODELS:

- SLV-3200: 2.5 GPM (9.5 L/min) Flow Rate Shower Head
- SLV-3200-E2: 2.0 GPM (7.6 L/min) Flow Rate Shower Head
- SLV-3200-E175: 1.75 GPM (6.6 L/min) Flow Rate Shower Head

FEATURES:

- CPT-SAL3200: Anti-Ligature Shower Valve Trim
- S-2460: 2.5 GPM (9.5 L/min) Flow Rate Shower Head
- S-2460-E2: 2.0 GPM (7.6 L/min) Flow Rate Shower Head used in SLV-3200-E2 Model.
- S-2460-E175: 1.75 GPM (6.6 L/min) Flow Rate Shower Head used in SLV-3200-E175 Model.

VALVE OPTIONS:

- CPV-PB: Pressure Balance Valve
Sweat & Thread Connections

STOCK FINISHES:



PC

STANDARDS:

- ASME A112.18.1/CSA B125.1 certified
- ADA compliant

WARRANTY:

Visit www.speakman.com for full product warranty information

- See Speakman.com For Warranty Information

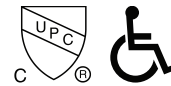

Information continues on next page

1. All dimensions are in inches (millimeters) unless otherwise specified and are subject to change without notice. 2. Unless otherwise specified all inlets and outlets are 1/2" female copper sweat and 1/2" male NPT. 3. For ADA mounting locations consult ADAAG, ANSI A117.1 or state regulations.

Architect/Engineer Approval Space:

P: 800-537-2107
F: 800-977-2747
W: WWW.SPEAKMAN.COM
R: 01-SEPTEMBER 2024

Anti-Ligature Trim and and Shower Combination (Valve not included)

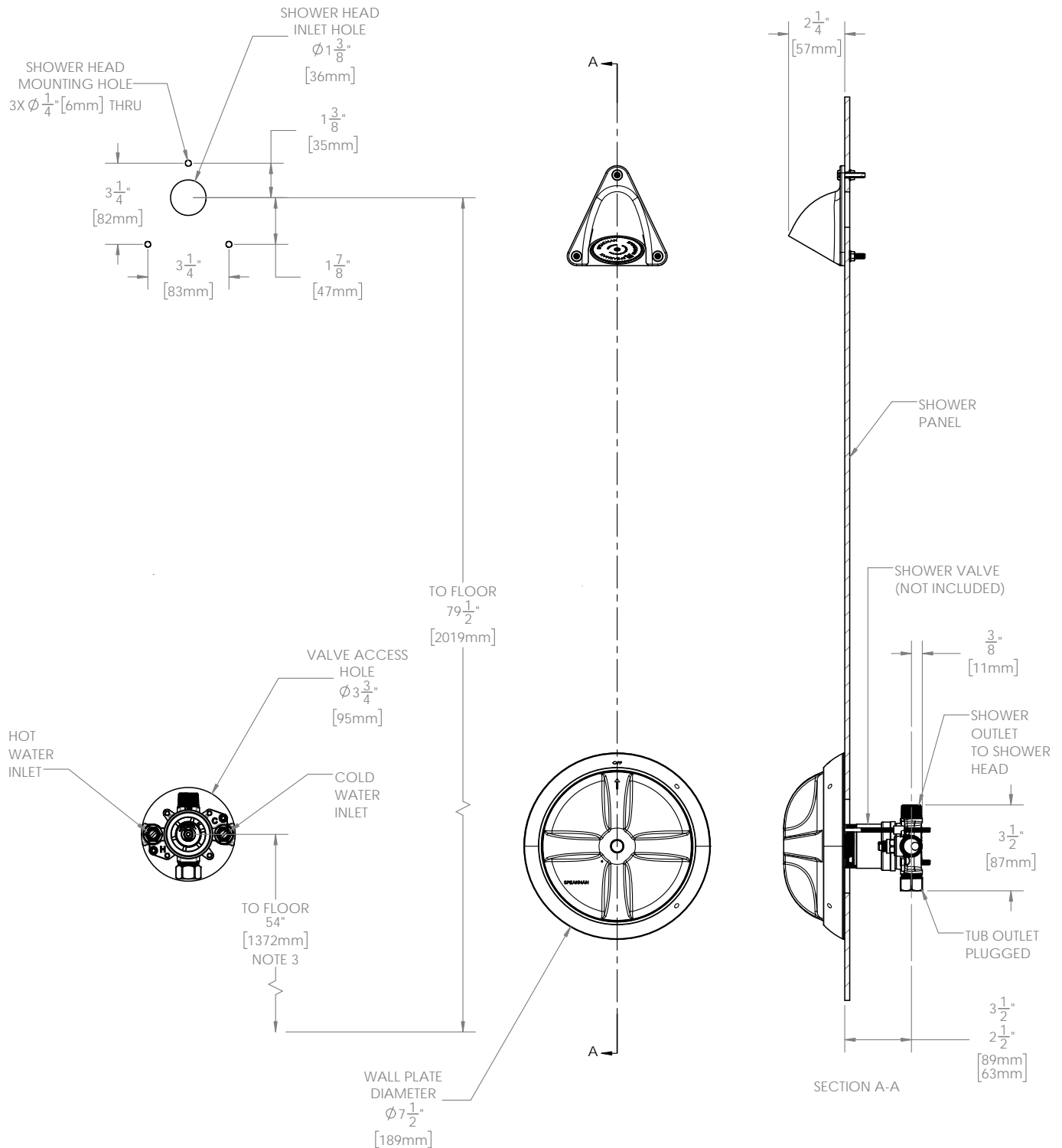

1. All dimensions are in inches (millimeters) unless otherwise specified and are subject to change without notice. 2. Unless otherwise specified all inlets and outlets are 1/2" female copper sweat and 1/2" male NPT. 3. For ADA mounting locations consult ADAAG, ANSI A117.1 or state regulations.

Architect/Engineer Approval Space:

P: 800-537-2107
F: 800-977-2747
W: WWW.SPEAKMAN.COM
R: 01-SEPTEMBER 2024

INSTALLATION INSTRUCTIONS

Anti-Ligature Shower Valve Trim

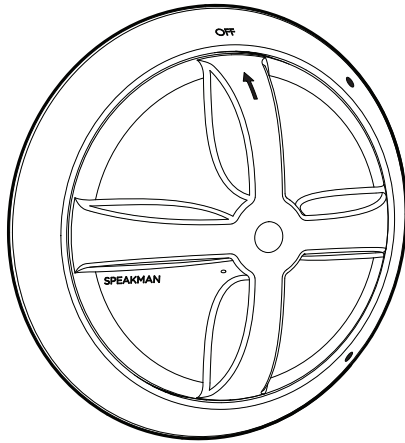

IMPORTANT

SAFETY TIPS:

Be sure to read and understand all instructions before beginning installation.

Cover the drain to avoid loss of parts.

Do NOT over tighten any connections or damage may occur.

Observe all local plumbing and building codes.

The Shower Valve has an optimal operating range of 20-80 psi

Periodic cleaning using a mild soap and warm water will help keep your product's appearance in its original condition.

For best results, dry immediately with a soft, clean cloth. DO NOT USE harsh and/or abrasive cleaners.

To help restore the finish, occasionally apply a non-abrasive wax to your product (follow manufacturers' instructions).

TOOLS & SUPPLIES NEEDED

Phillips
Screwdriver

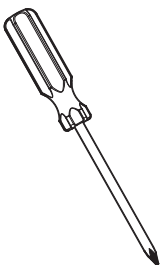

Security
Key Wrench
(Included)

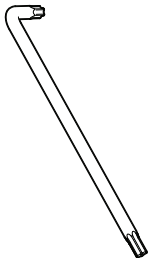

WAIVER DISCLAIMER

This waiver-disclaimer is attached to and made part of the written contract to purchase these products for use in psychiatric and correctional facilities. Such fixtures and products are purchased to reduce the risk of self-imposed death or injury to patients or clients in such facilities, but are NOT represented as able to prevent such death or injury.

Speakman Company as the seller and manufacturer of these products have not, and will not represent or warrant to the purchaser shown in this contract ("Purchaser") that its fixtures and products will prevent death or injury in any case whatsoever.

Speakman Company makes no expressed or implied warranty with respect to the preventative quality of its products, but merely represents that the use of such products tends to reduce deaths and injuries by patients or clients who are subject to meticulous screening processes and diligent supervision on the part of the facility housing them.

Purchaser acknowledges the foregoing disclaimer and waives any and all claims against Speakman Company as to expressed or implied warranties of fitness for any purpose whatsoever.

INSTALL SPLINE ADAPTER

- 1 Remove the Protective Cover from Valve. Ensure the Valve is in the "OFF" position. Slide Splined Hex Shaft over the Valve Spindle, followed by Flat Washer, Lock Washer, and secure with Screw.

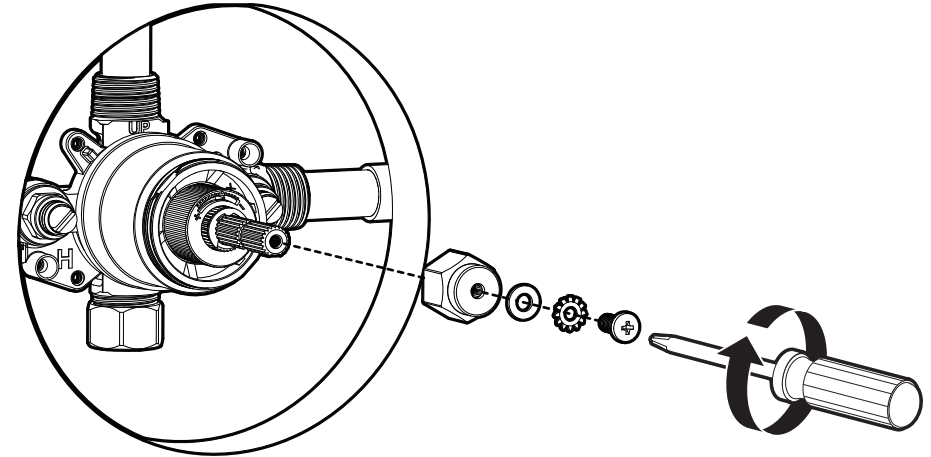

INSTALL WALL PLATE

- 2 Orient Wall Plate with the "OFF" marking at the top position as shown below. Place Wall Plate over the Hex Spline Adapter. Secure Wall Plate to the Shower Valve with the Screws provided.

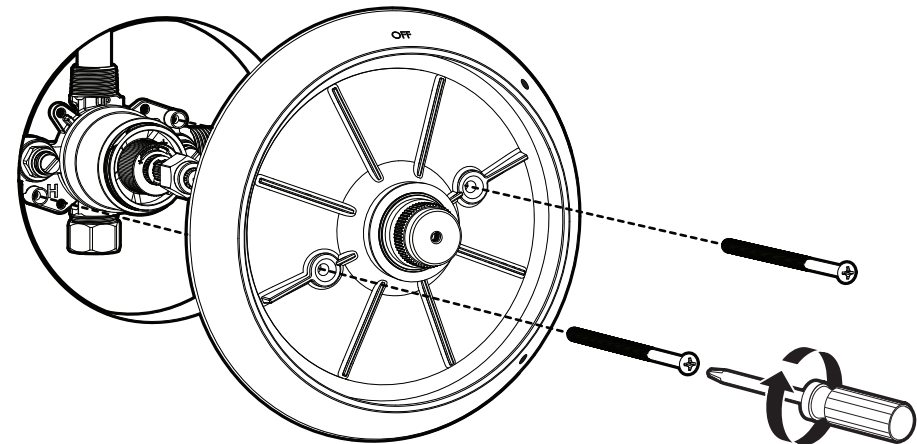

INSTALL HANDLE ASSEMBLY

- 3** Verify Friction Ring is properly seated into the Friction Ring Groove of the Wall Plate (A). Orient the Handle Assembly, as shown below, with the arrow facing upwards. Install the Handle Assembly over the Wall Plate Splined Shaft. Secure with the Security Screw using the supplied Key Wrench. Verify smooth rotation of the Handle Assembly.

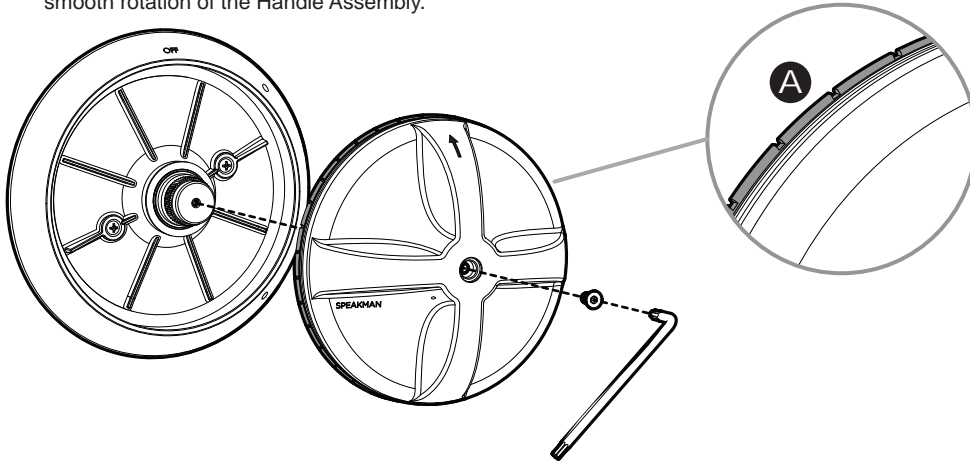

INSTALL SCREW COVER

- 4** Insert Screw Cover with O-Ring installed, into recess of Handle.

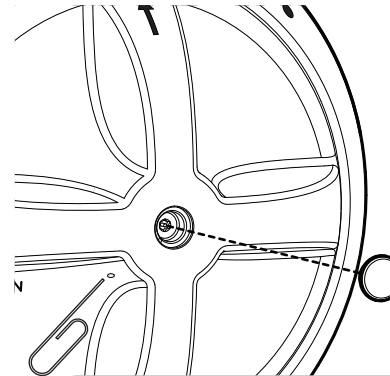

MAINTENANCE NOTE

To remove the Screw Cover for maintenance, insert a Paper Clip or similar item into the .04" access hole within the Handle Assembly as shown.

PRODUCT WARRANTY

For additional information please go to www.speakman.com.

CALIFORNIA PROPOSITION 65



CALIFORNIA PROPOSITION 65:
WARNING: This product can expose you to chemicals including lead, which is known to the State of California to cause cancer and birth defects or other reproductive harm. For more information go to www.P65Warnings.ca.gov. Wash hands after installation, repair, or removal of this product.

REPAIR PARTS

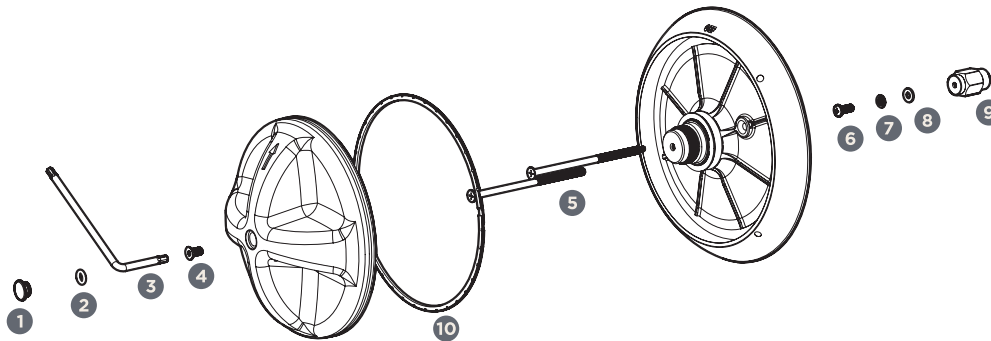

ITEMS 1-9
RPG48-0046

Valve Trim Mounting Hardware

ROUGH-IN DIAGRAM

COMPLIANCE:

ASME A112.18.1/CSA B125.1

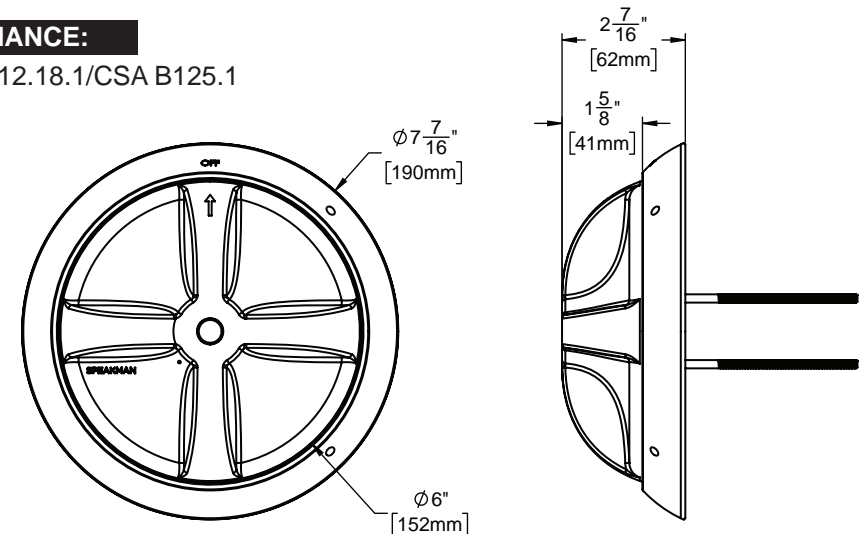

NEED HELP?

For additional assistance or service please contact:



800-537-2107



customerservice@spekman.com



www.speakman.com

INSTALLATION INSTRUCTIONS

S-2460
Vandal Resistant Shower Head

S-2460-AP
Vandal Resistant Shower Head
with Anchor Plate

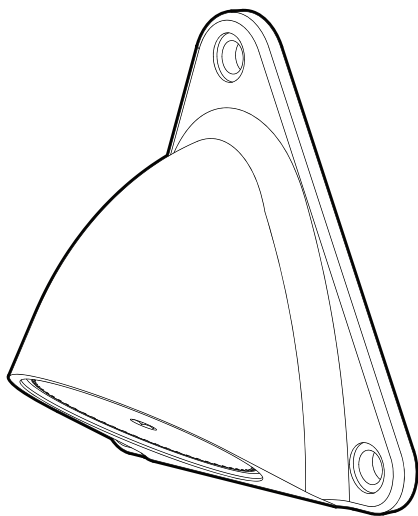

92-S-2460-01

TOOLS & SUPPLIES NEEDED

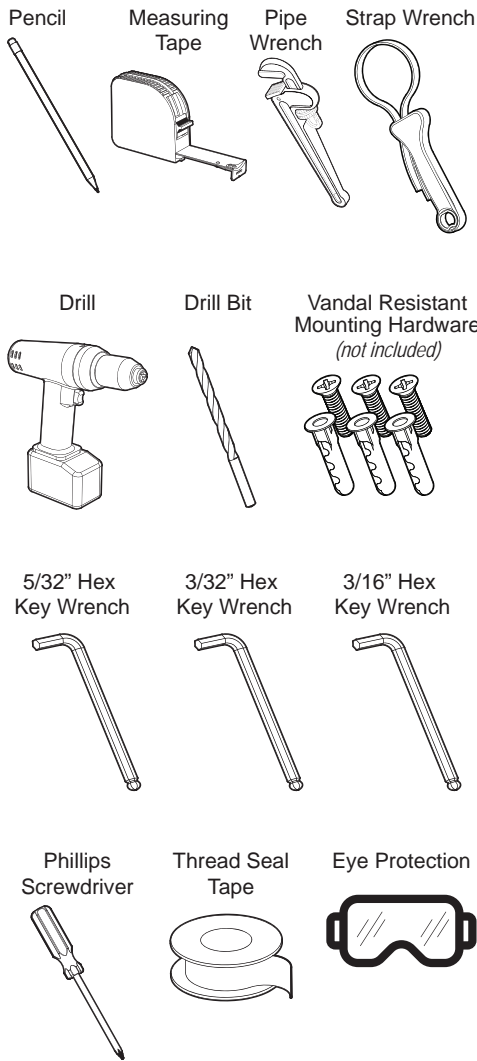

IMPORTANT

SAFETY TIPS:
Be sure to read and understand all instructions before beginning installation.

Inspect all connections after installation.

Cover the drain to avoid loss of parts.

Be sure to wear proper eye protection.

Do NOT over tighten any connections or damage may occur.

Shut OFF water supplies before beginning installation.

Observe all local plumbing and building codes.

SPECIFICATIONS:
This Shower Head has an operating range of 20-80 psi.

CAUTION

Ensure proper structure is in place to support the Shower Head and plumbing during use.

MAINTENANCE

Your new product is designed for years of trouble-free performance.

FINISH MAINTENANCE:
Your new product is designed for years of trouble-free performance. Keep it looking new by cleaning it periodically with a soft cloth. Avoid abrasive cleaners, steel wool, and harsh chemicals as these will dull the finish and void your warranty.

WARNING

CALIFORNIA PROPOSITION 65:
WARNING: This product can expose you to chemicals including lead, which is known to the State of California to cause cancer and birth defects or other reproductive harm. For more information go to www.P65Warnings.ca.gov. Wash hands after installation, repair, or removal of this product.

WARRANTY

Visit www.speakman.com for full warranty information.

NEED HELP?
For additional assistance or service please contact: 800-537-2107 www.speakman.com

SITE PREPARATION

- 1 Ensure mounting location and structure are capable of supporting the product in use. When mounting the Shower Head, it is recommended that the screws be fastened into wood blocking or other substantial substrate.

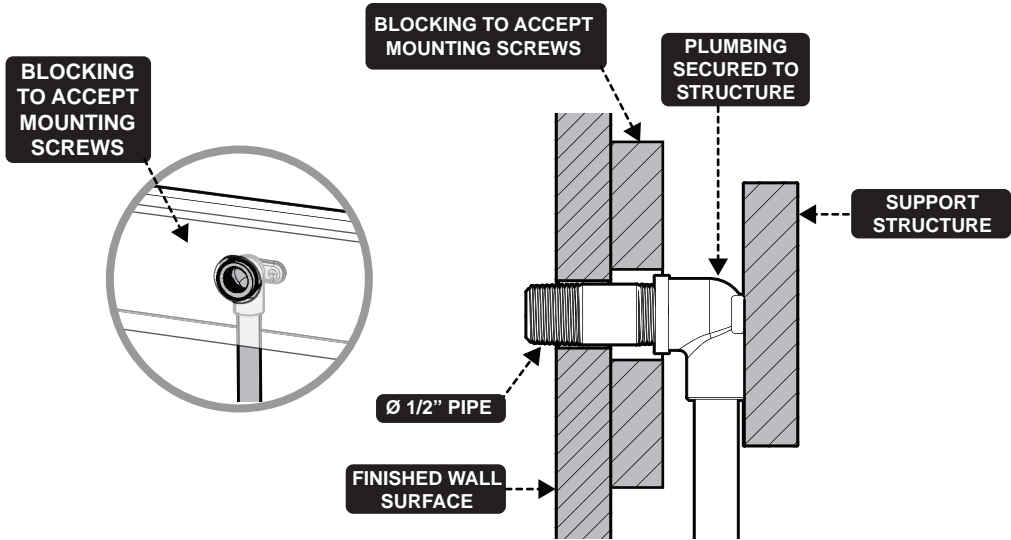

INSTALL PIPE NIPPLE

- 2 Determine the length of the Ø 1/2" Pipe needed by following the diagram below. When properly installed the Ø 1/2" Pipe should extend from the finished wall per the dimensions. Ø 1/2" Pipe Nipple is not included.

Apply Thread Seal Tape to the end of the Pipe Nipple entering the wall. Wrench tighten Pipe Nipple into place.

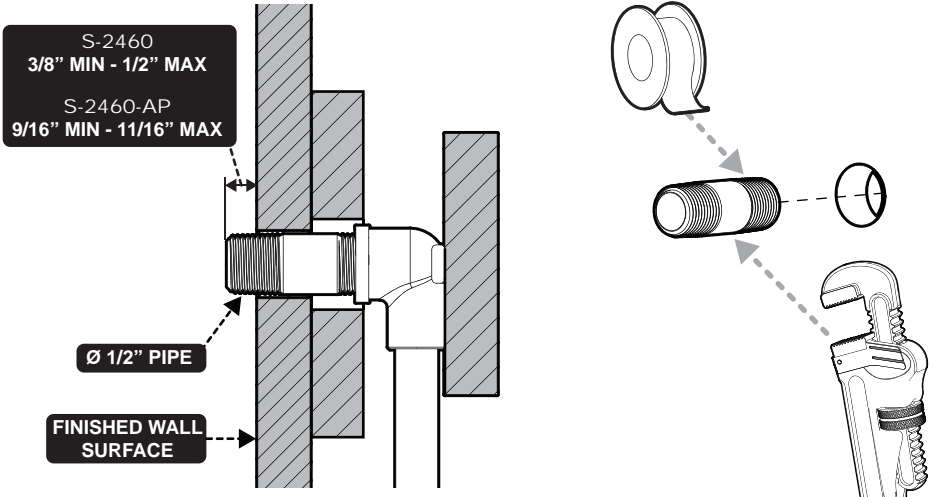

TEST INSTALLATION

- 3 Thread Shower Head onto the Pipe Nipple using a Strap Wrench or Soft Jawed Pliers. Align mounting holes into the final desired position.

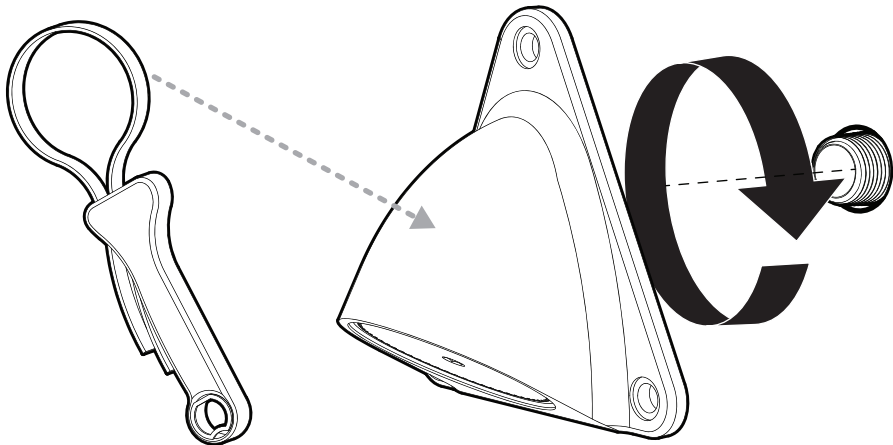

MARK MOUNTING LOCATIONS

- 4 Use a Pencil to mark the mounting hole locations. If installing the optional Anchor Plate (AP), trace the outline of the Shower Head onto the wall. After marking the mounting hole locations, remove the Shower Head.

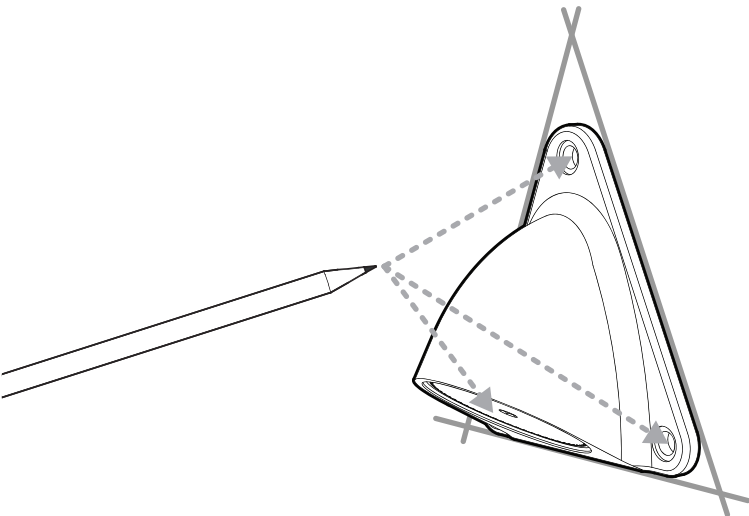

MARK MOUNTING LOCATIONS (ANCHOR PLATE OPTION)

- 5 If installing the optional Anchor Plate (AP), align the Anchor Plate to the traced outline and mark the inner mounting holes onto the wall.

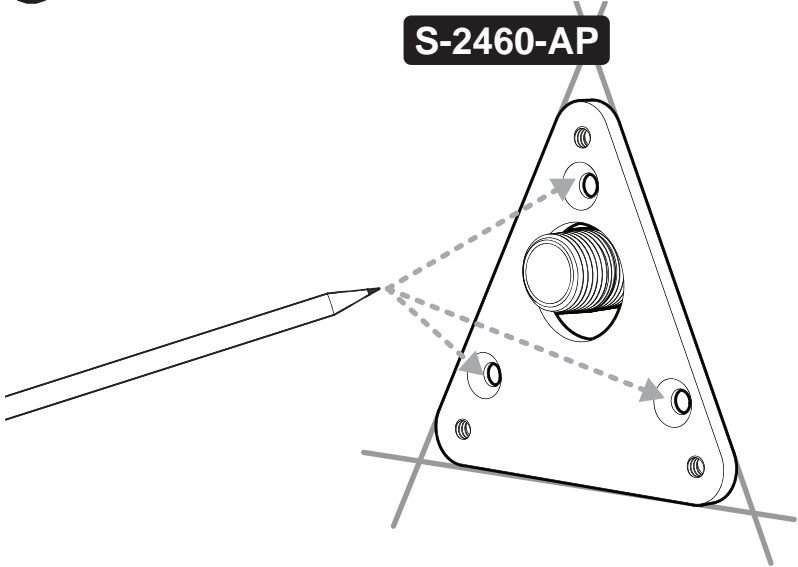

DRILL MOUNTING HOLES

- 6 Select a Drill Bit that is the appropriate type and size for the mounting hardware being used. If installing the S-2460, use the outer marked holes. If installing the optional Anchor Plate (AP) S-2460-AP use the inner set of marked holes. (Vandal Resistant Mounting Hardware is not included and should be selected based upon the location materials.)

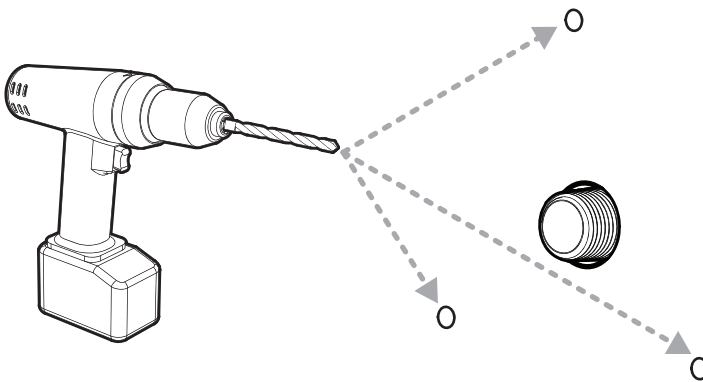

INSTALL ANCHOR PLATE (ANCHOR PLATE OPTION)

- 7 If installing the optional Anchor Plate, secure to the wall with Mounting Hardware. (Flat Head Mounting Hardware with a countersunk head is recommended, but not included)

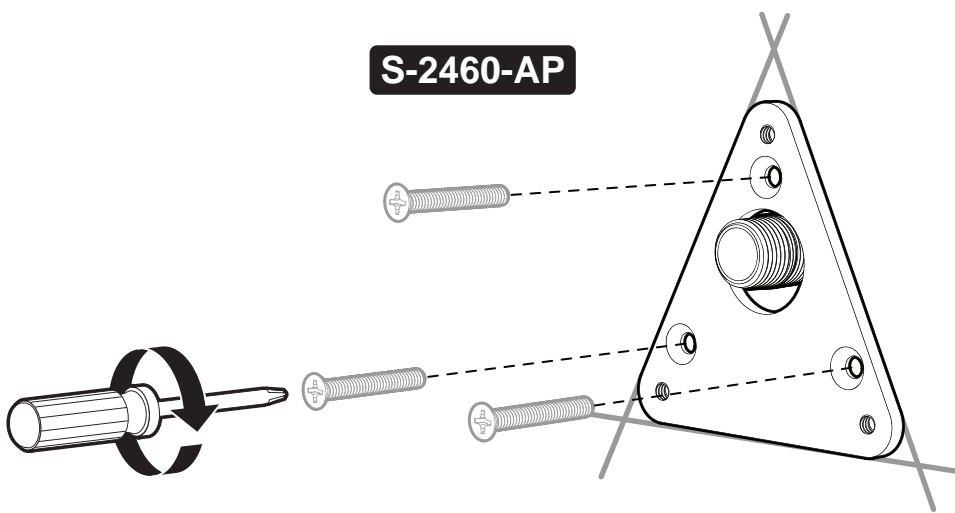

REINSTALL SHOWER HEAD

- 8 Apply Thread Seal Tape to remaining end of Pipe Nipple. Reinstall Shower Head using a Strap Wrench or Soft Jawed Pliers. Align Mounting Holes in Shower Head to the previously drilled mounting holes.

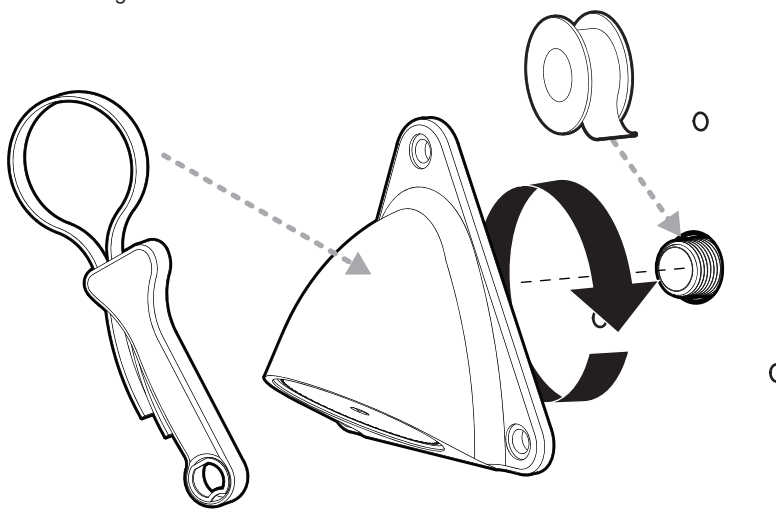

SECURE INTO FINAL POSITION

9

S-2460

Secure Shower Head into position using Vandal Resistant Mounting Screws. (Vandal Resistant Mounting Hardware is not included and should be selected based upon the location materials.)

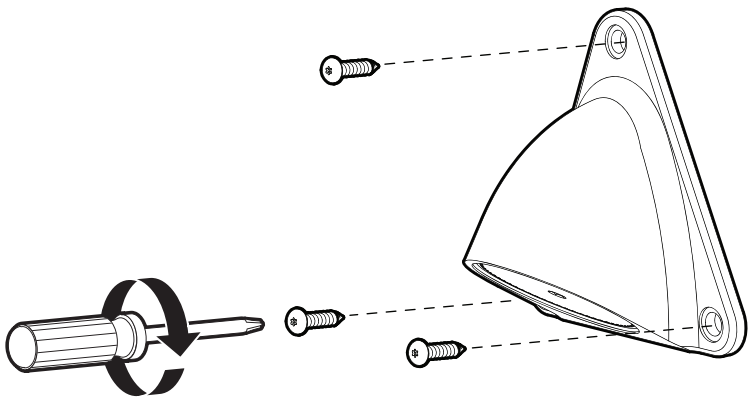

S-2460-AP

Secure Shower Head onto the previously mounted Anchor Plate using the included Vandal Resistant Mounting Hardware and a 5/32" or 4mm Hex Key Wrench

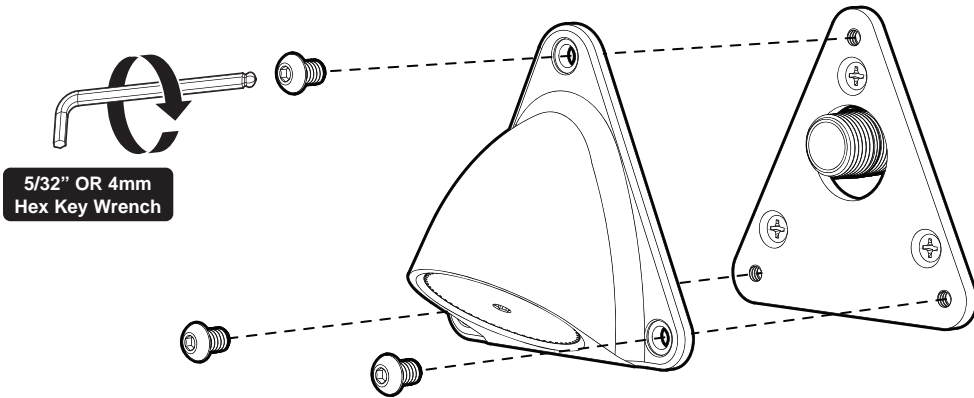

SPRAY ADJUSTMENT

- 10 Loosen side Set Screw using a 3/32" (2.4mm) Hex Key Wrench (A), Adjust the spray pattern using a 3/16" (4.8mm) Hex Key Wrench (B). Tighten side Set Screw to secure desired spray pattern (A).

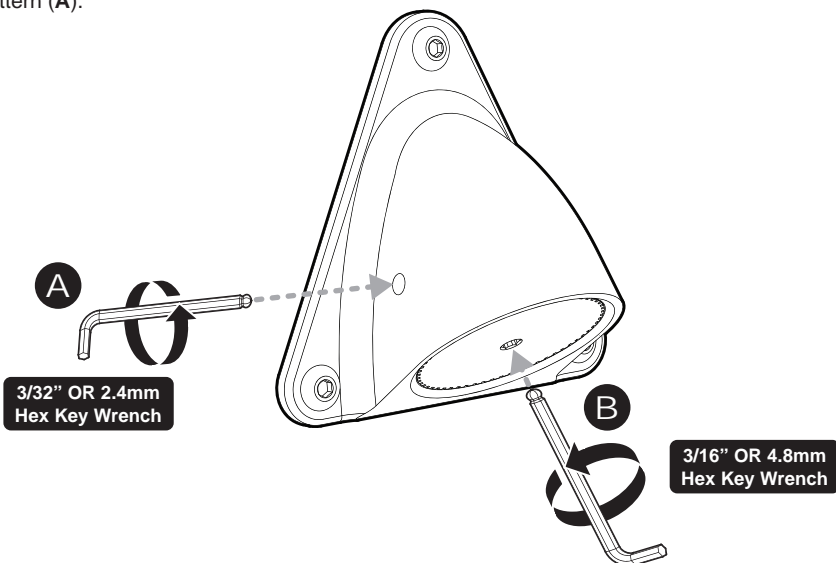

ROUGH IN DIAGRAM

